

Level controllers

SM... float switches

The rising or falling liquid level causes the float to move slightly up or down. When the float rises, it activates a microswitch (changeover contact).

These units are not suitable for use in turbulent liquids (e.g. in stirrer tanks).

 versions also available. Detailed information on request.



SM/P/3



SMG/P/3



SMG/P/3 with PP square flange

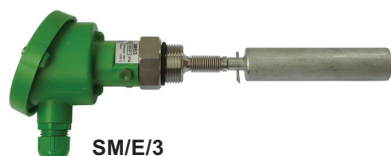

SM/E/3



SMG/E/3



SMG/E/3 with stainless steel square flange and horizontal extension piece for the float

Technical data	SM/P/3	SMG/P/3	SM/E/3	SMG/E/3
Application	for standard applications. For light current applications on request.			
Switching voltage	between AC/DC 24 V and AC/DC 250 V			
Switching current	between AC 20 mA and AC 5 A			
Switching capacity	or between DC 20 mA and DC 100 mA max. 1,000 VA			
Operating principle	microswitch, potential-free changeover contact			
Float	PP, Ø 29 mm x 133 mm	Ø 63 mm x 140 mm; on request: ball float Ø 85 mm	stainless steel 316 Ti, Ø 28 mm x 120 mm	Ø 63 mm x 140 mm on request: ball float Ø 95 mm
On request: extension piece for the float	—	—	—	horizontal or vertical
Bellows material	PP		stainless steel 316 Ti	
Screw-in nipple	PP, G1		stainless steel 316 Ti, G1	
Flange	on request: square blind flange with G1 threaded hole made of PP, PVDF or stainless steel 316 Ti stainless steel 316 Ti or other flanges with any desired dimensions			
Float, bellows and screw-in nipple protection class	IP68			
Connection head	PP with M 20 x 1.5 cable entry, protection class IP54; on request: connection head made of cast aluminium, protection class IP54			
Mounting orientation	horizontal			
Temperature range	0°C to + 90°C (inside the connection head: 0°C to + 60°C)		0°C to + 100°C	
Pressure resistance/ test pressure	for pressureless applications / test pressure: max. 2 bar at + 20°C test pressure max. 2 bar only for versions without flange or with flange made of stainless steel; with square flange made of PP or PVDF: 0 bar		—	on request: 0°C to + 250°C (inside the connection head: 0°C to + 100°C) on request: up to max. 4 bar at + 20°C and ≥ 1.0 g/cm³ / test pressure: max. 6 bar at + 20°C
Application	≥ 0.82 g/cm³	only for use in liquids with a specific gravity ≥ 0.7 g/cm³		≥ 0.7 g/cm³ (without extension piece)

SM/P/3

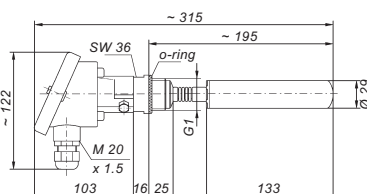

SMG/P/3

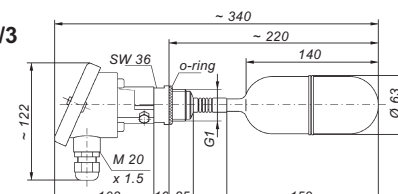

SM/E/3

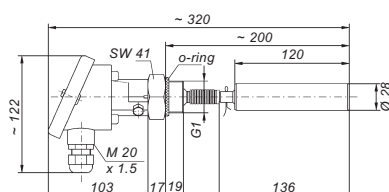

SMG/E/3

